

Radar Vehicle Detector For Barrier Gate

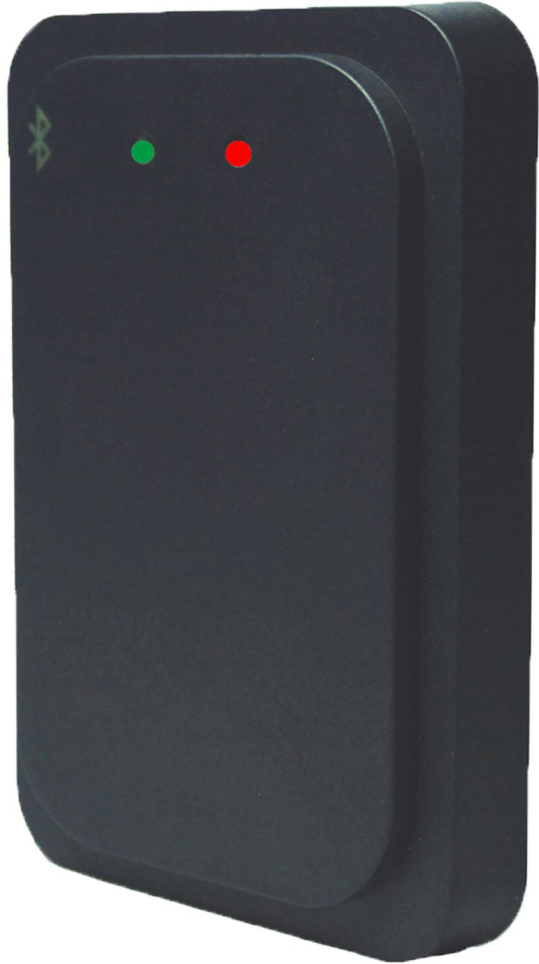

Scan QR Code
Radar Assistant APP
For Android



Radar Assistant is in
Apple App Store



CONNECT DEVICE

Work mode

Bluetooth address

Bluetooth name

MODIFICATION

Hardware ver.

Firmware ver.



Open Bluetooth and Click Connect Device

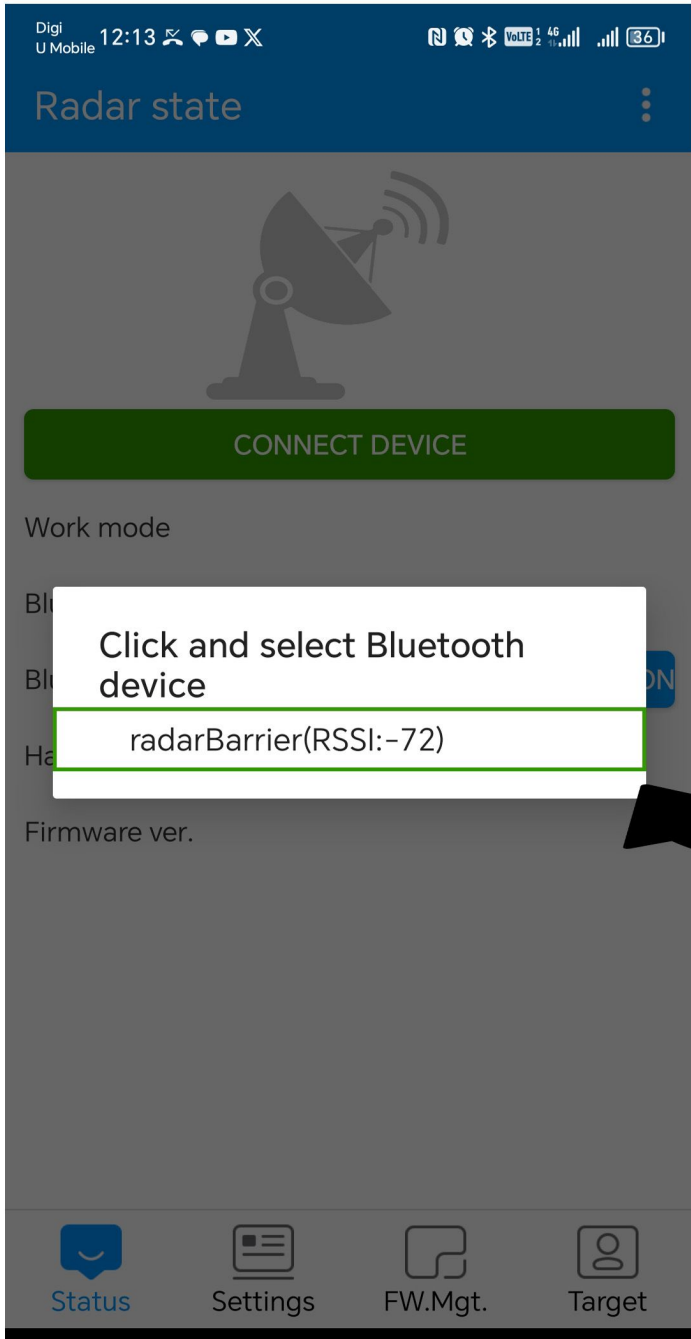

Select Radar Device



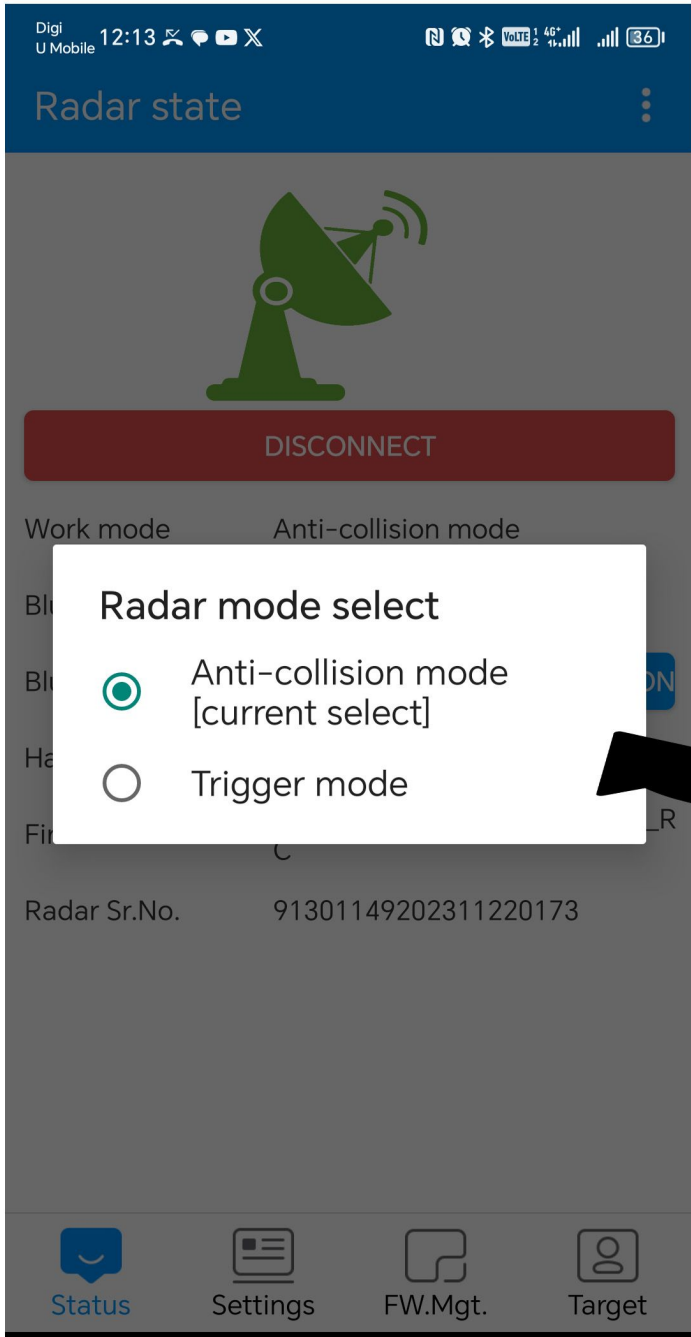

**For Barrier Gate
Select Anti-Collision Mode**

RESTART(CALL RADAR)

REQUEST RADAR PARAMETERS

Boom type Straight boom **SELECT**

Left detect scope << 0.7m >>

Right detect scope << 0.7m >>

Max. detection range << 3.0m >>

Min. undected range << 0.2m >>

Human/Vehicle Distinction << No Classification >>

RESTORE FACTORY SETTING

SAVE

BACKGROUND LEARNING

FOR SETTING TIPS

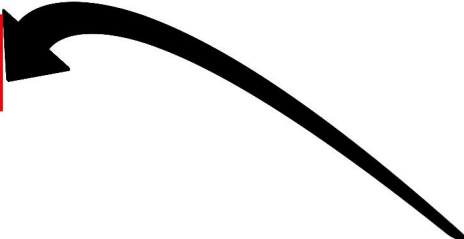

Dont Adjust

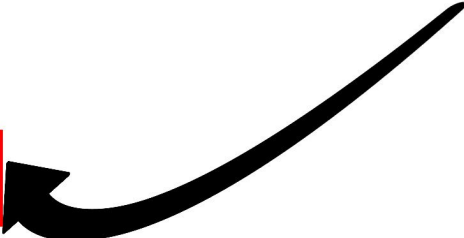

After Adjust Click Save

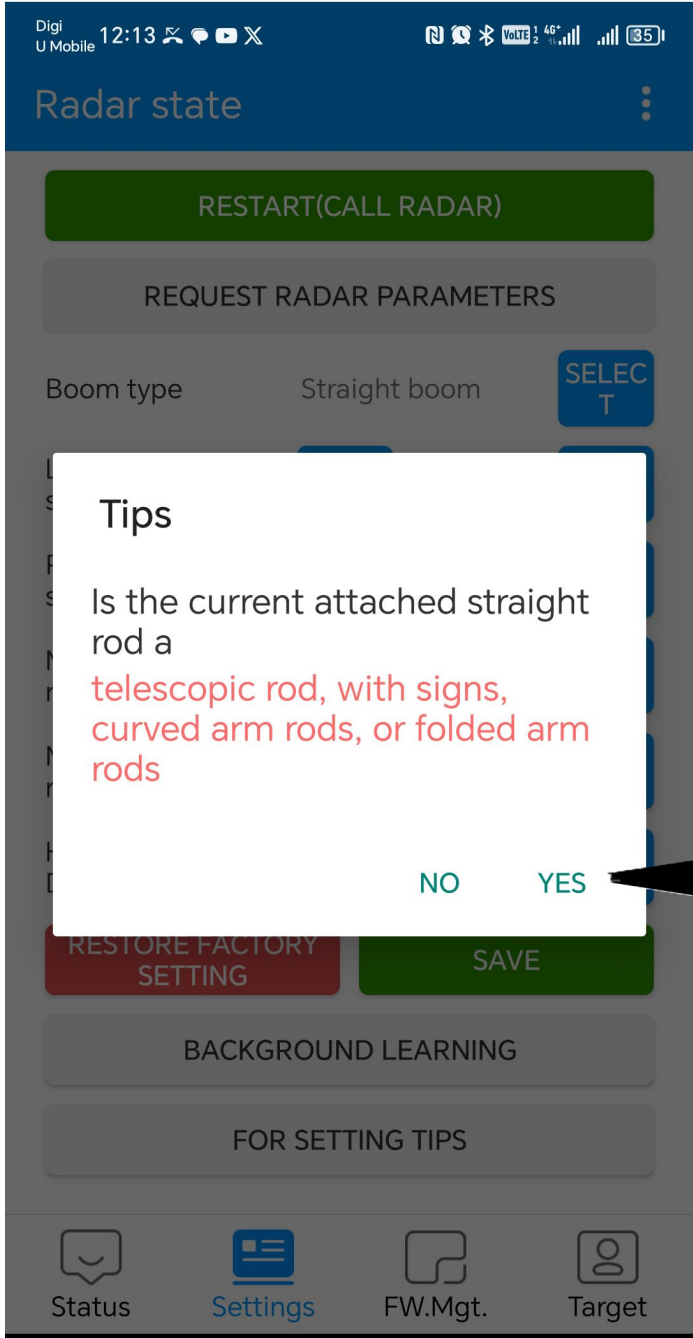

Then Click Yes

Tips

When facing radar:

- The straight pole is on the left side of the radar
- The straight pole is on the right side of the radar

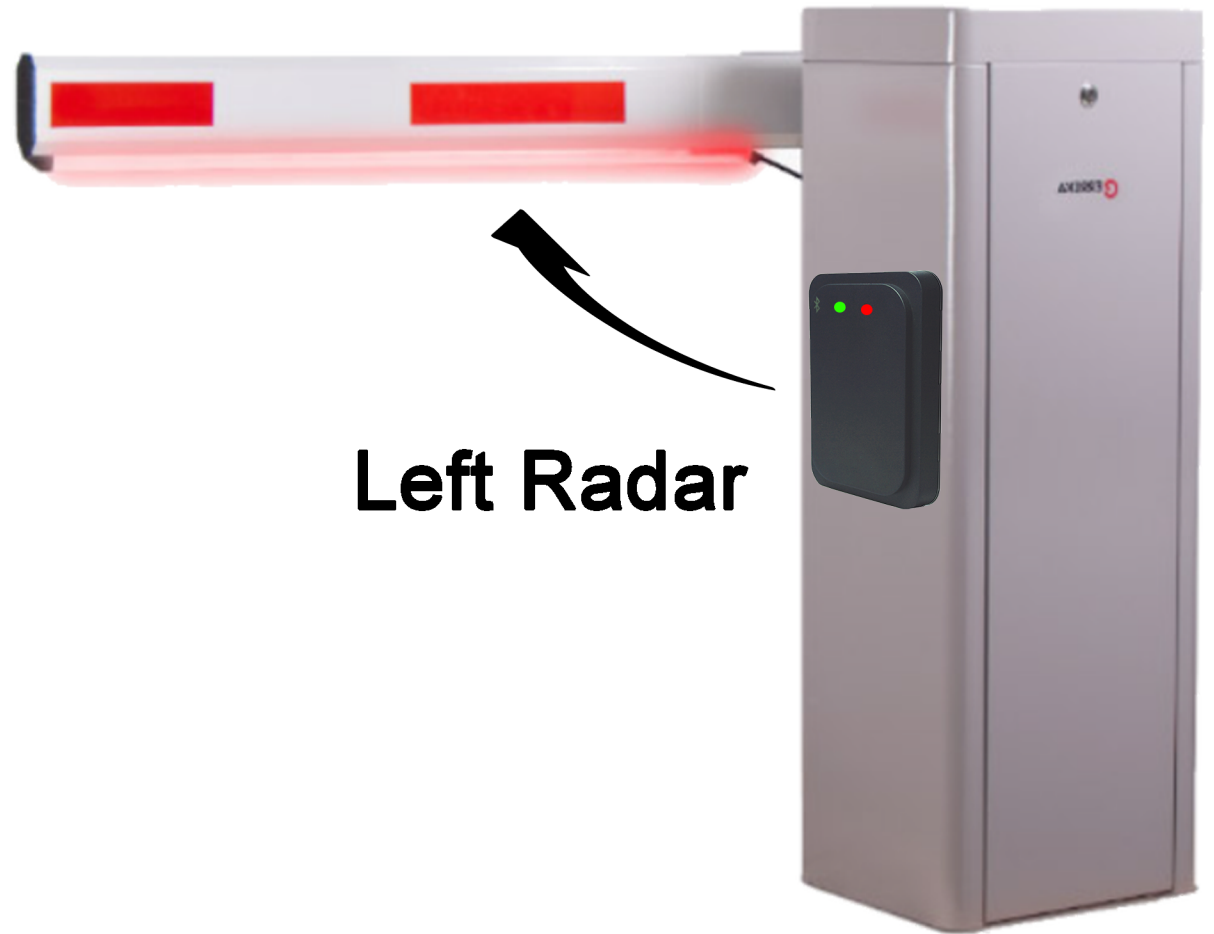
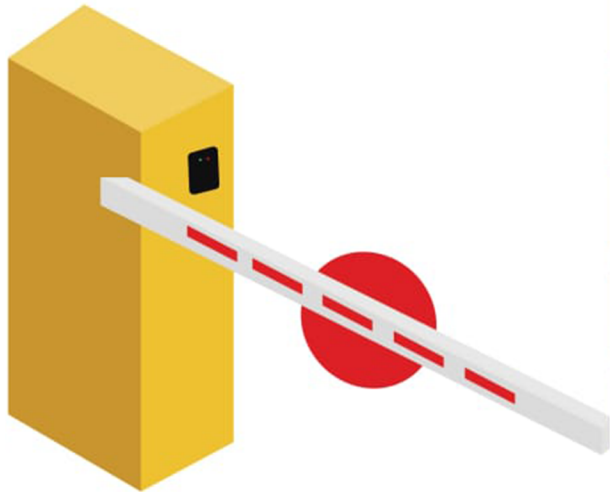

Left Radar



Right Radar

Tips

When facing radar:

- The straight pole is on the left side of the radar
- The straight pole is on the right side of the radar

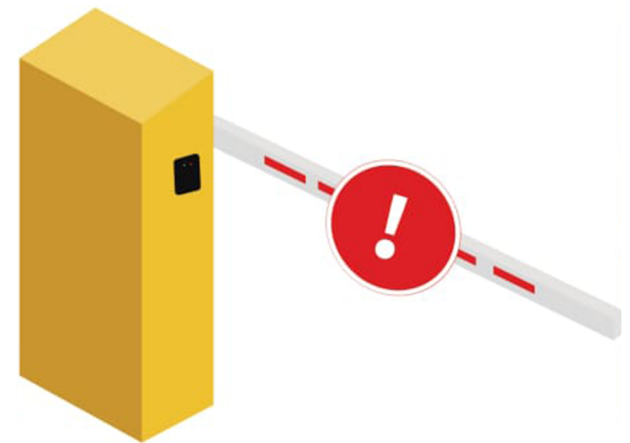

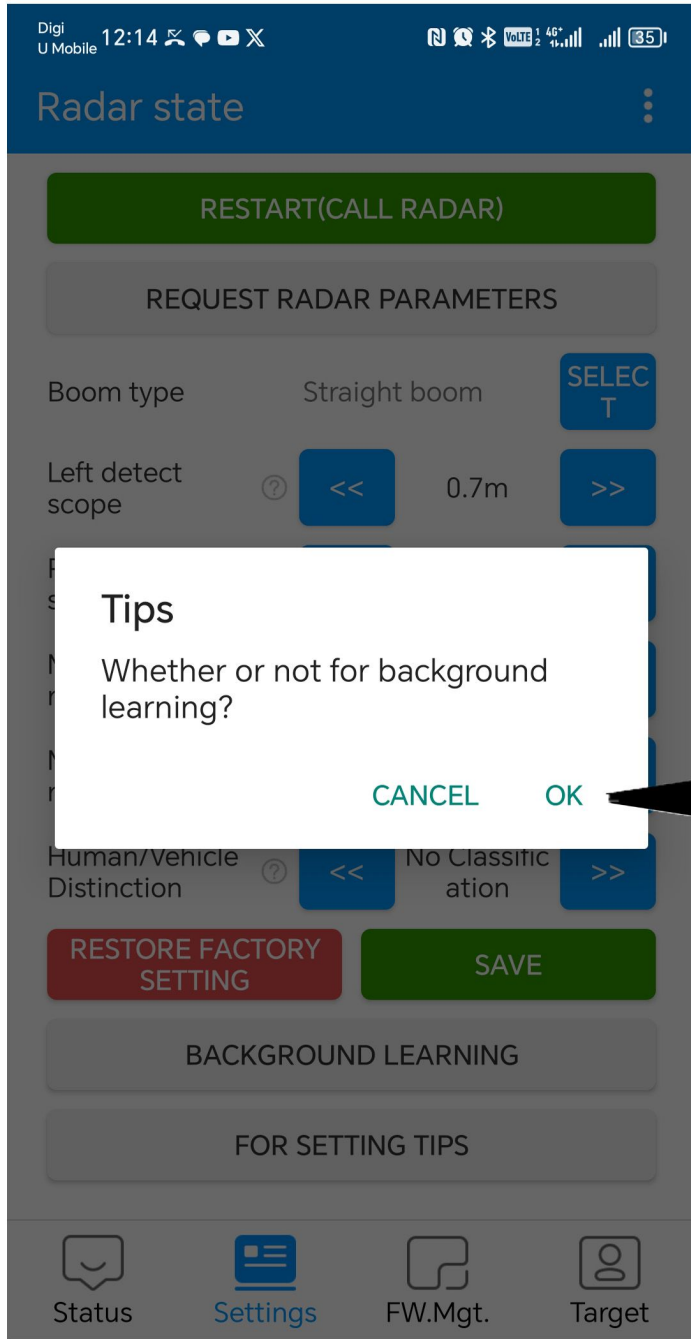

Click Okay For Background Learning

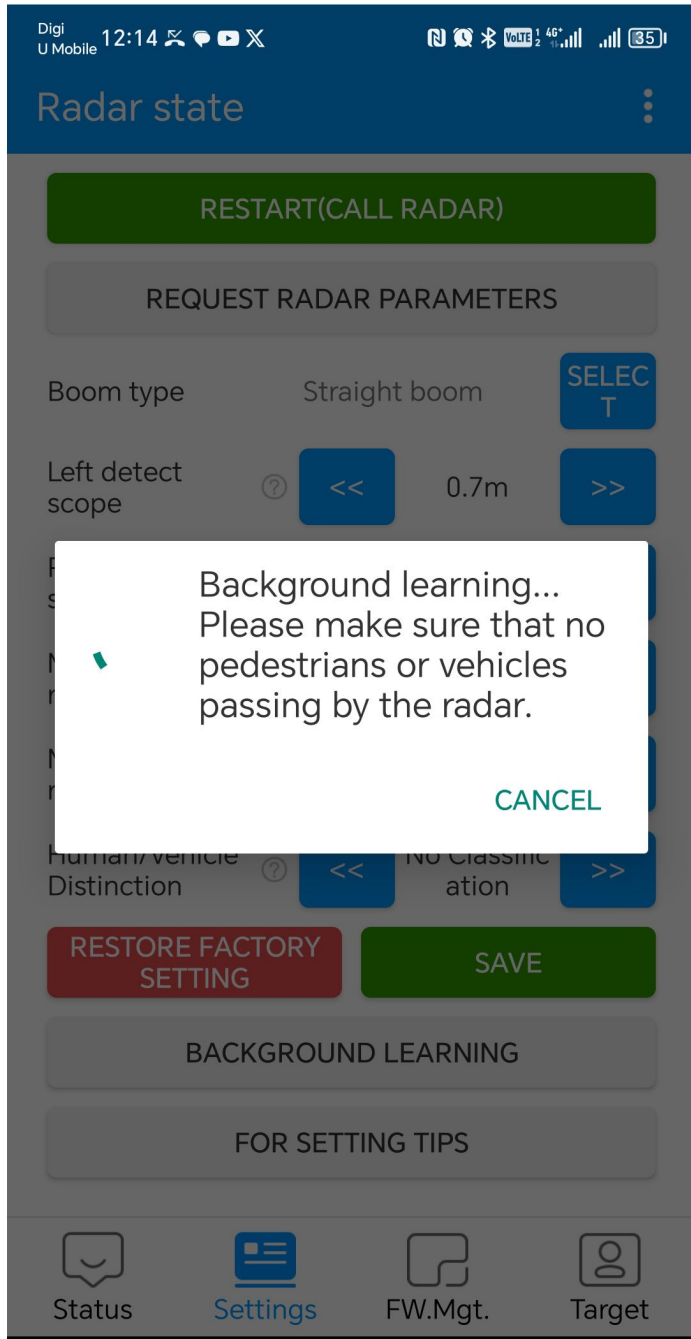

Make Sure Dont Have Vehicle Pass By The Radar

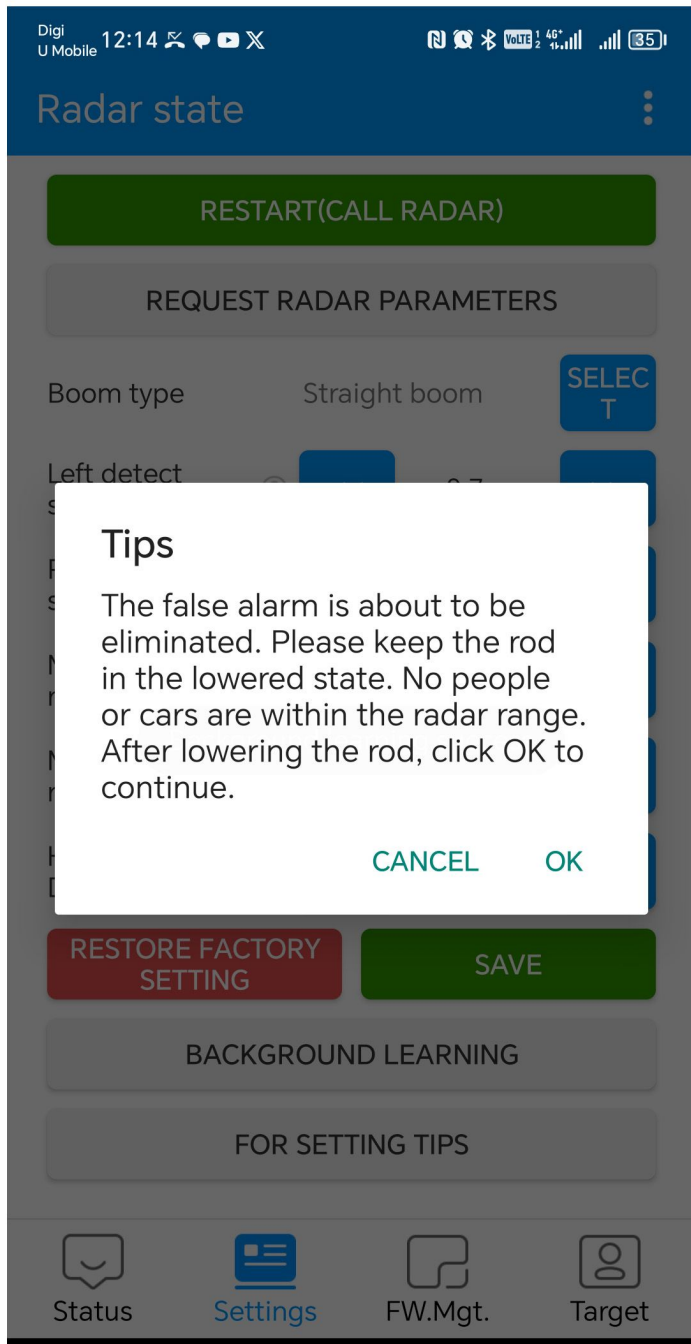

Click OK After Lowering The Rod

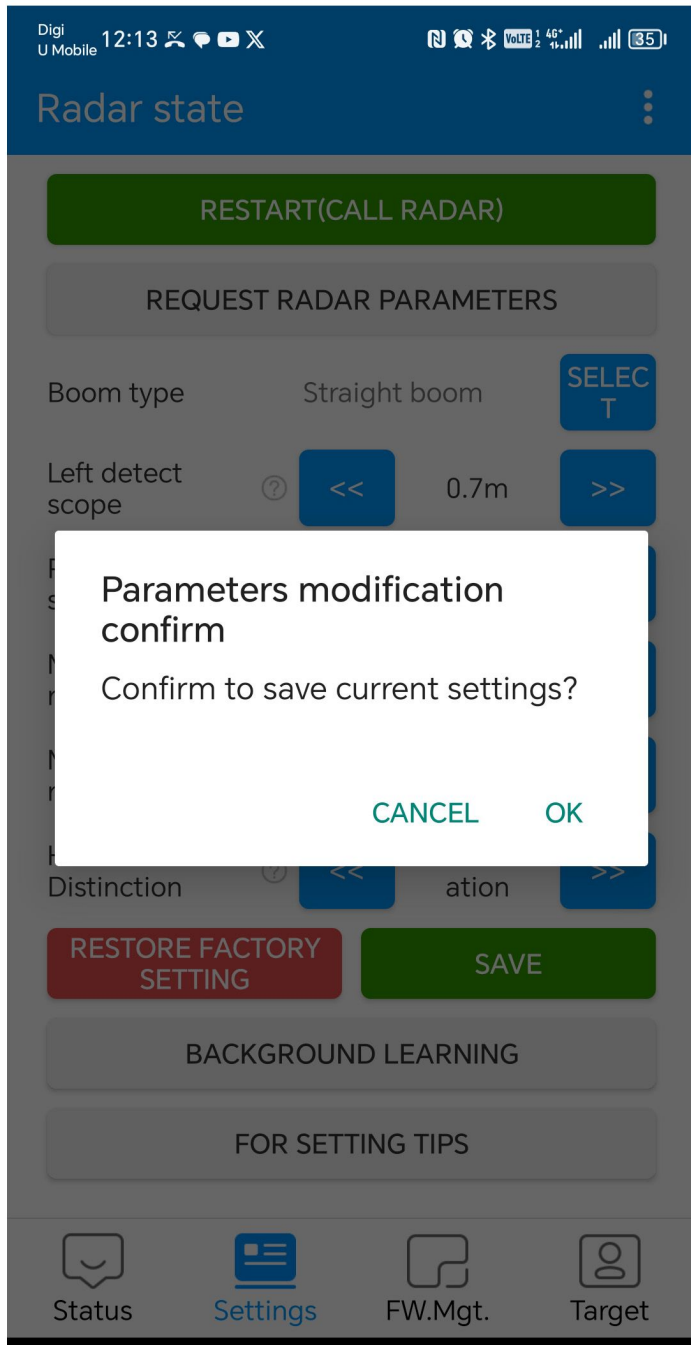

Click OK After Confirm
Save Settings

