

Minimum Device

requirement :

1 x HomeRevon Smart
Switch

1 x HomeRevon PIR Mo-
tion Sensor

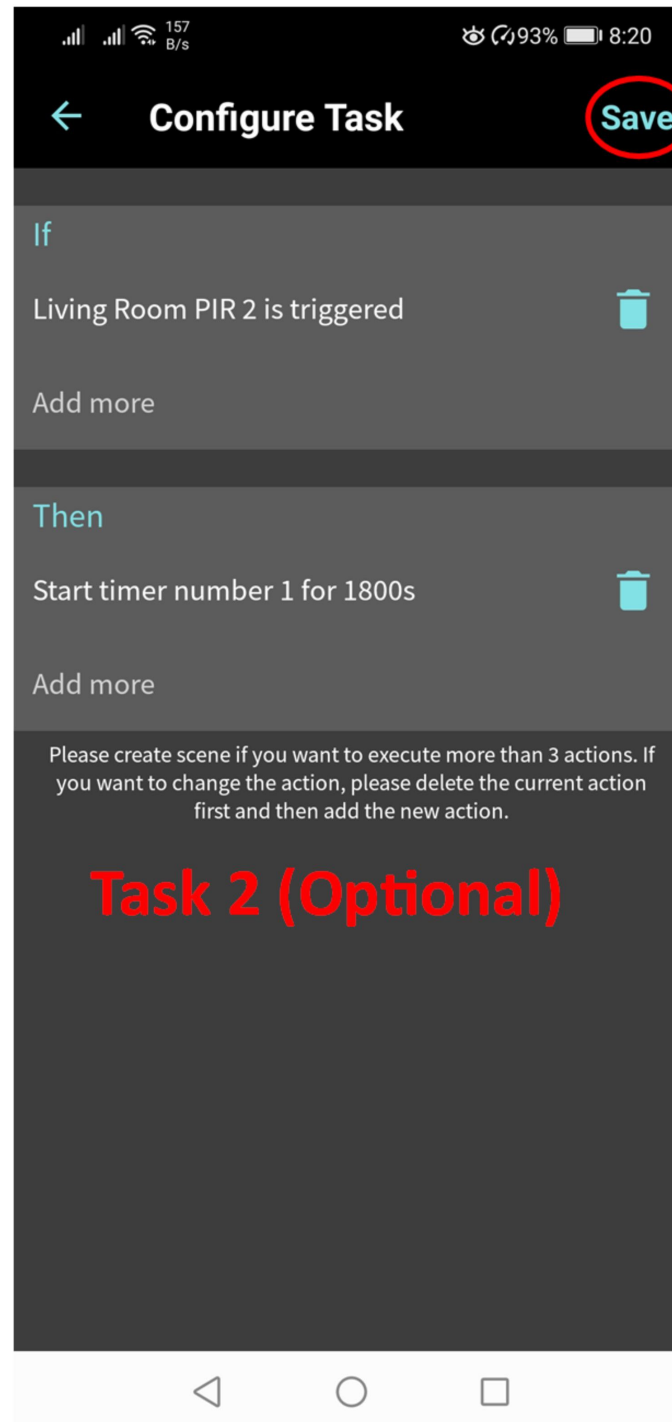

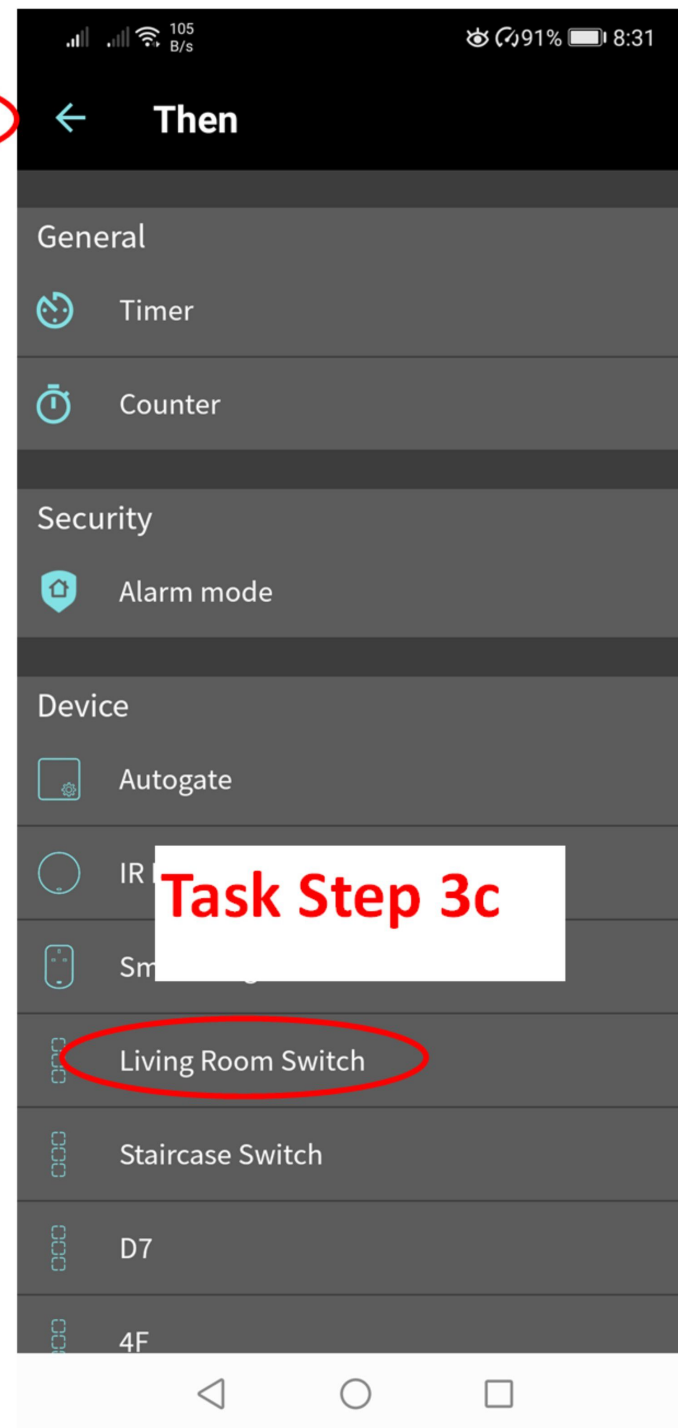
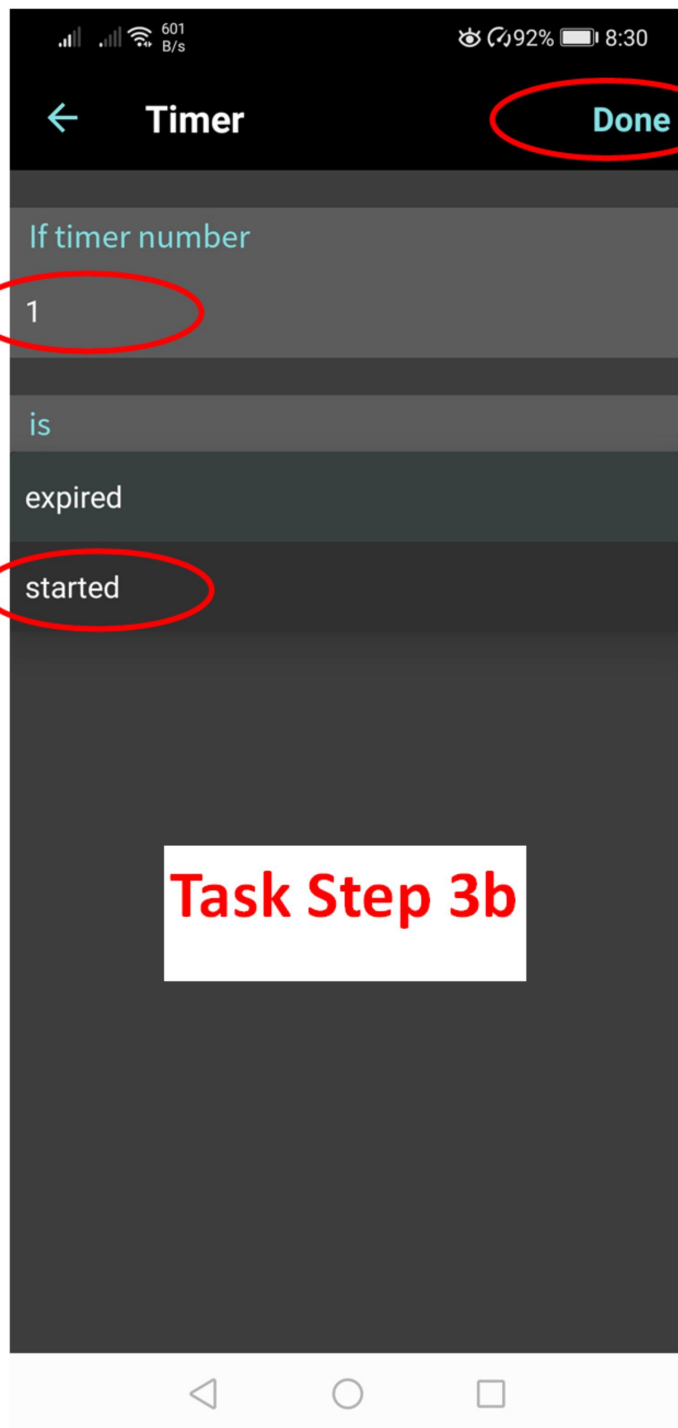
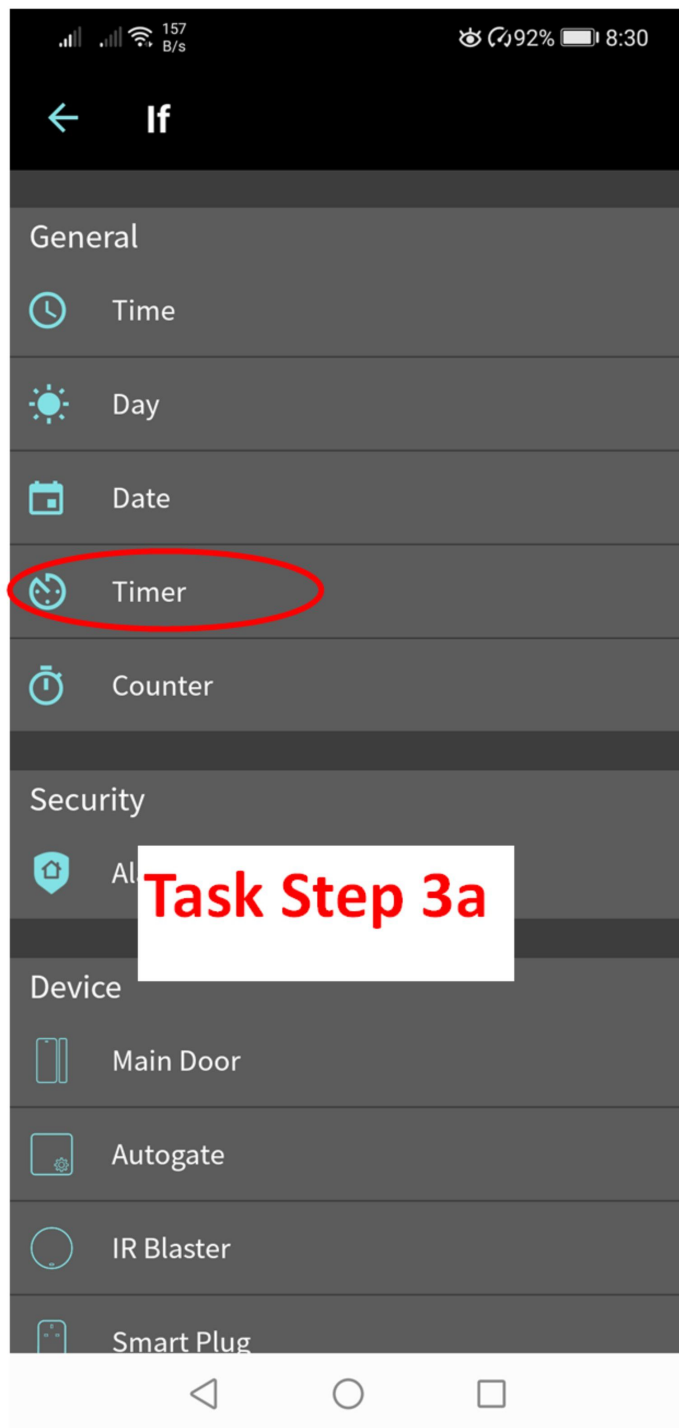

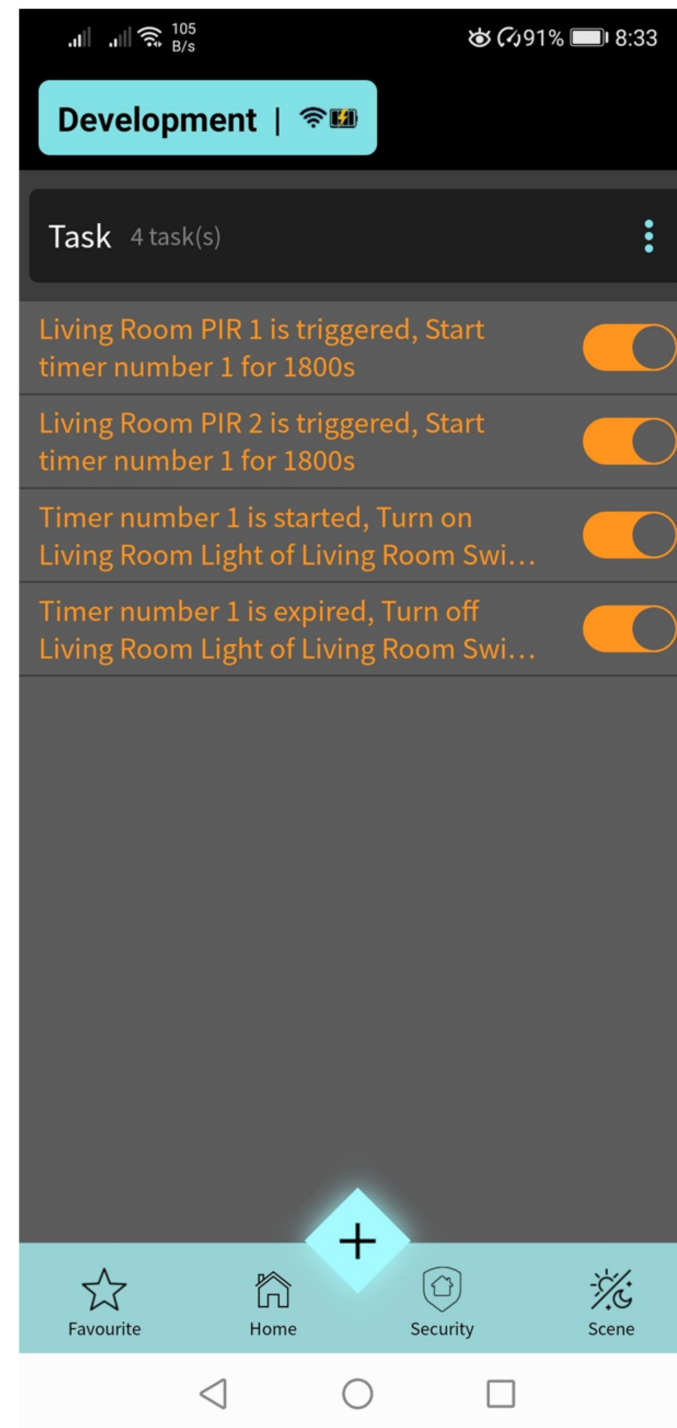
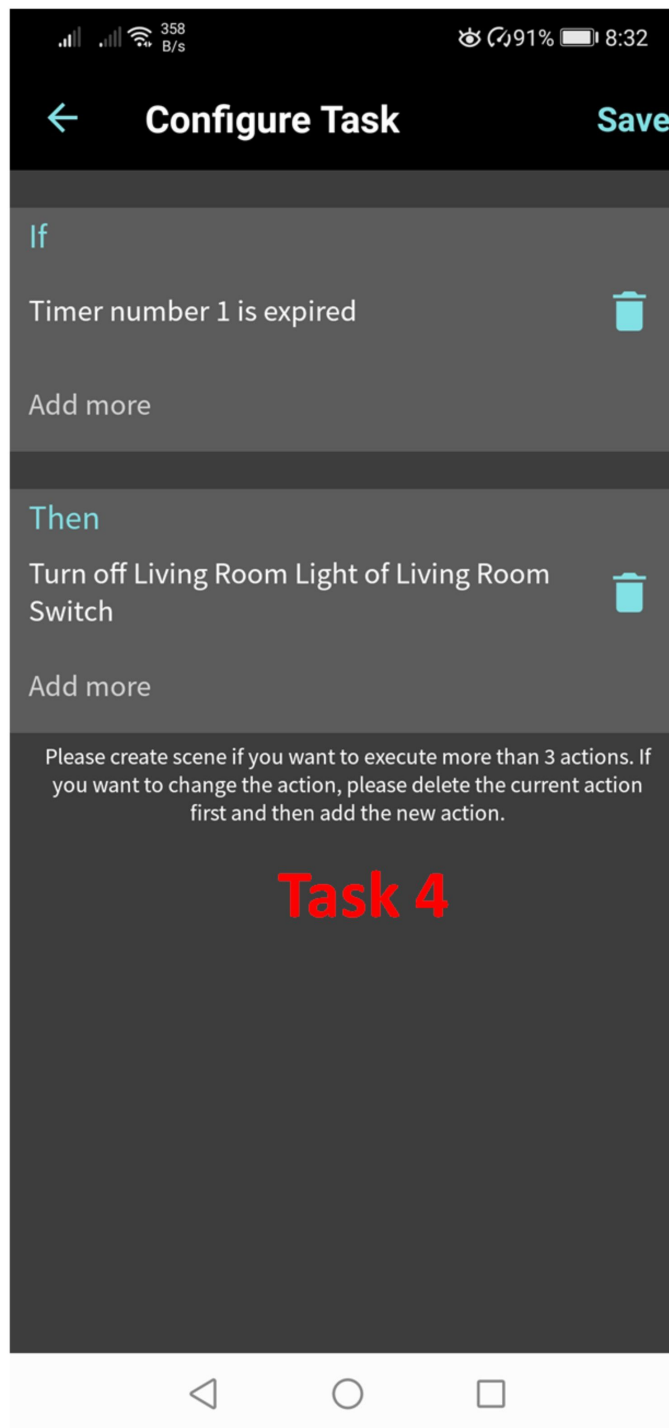
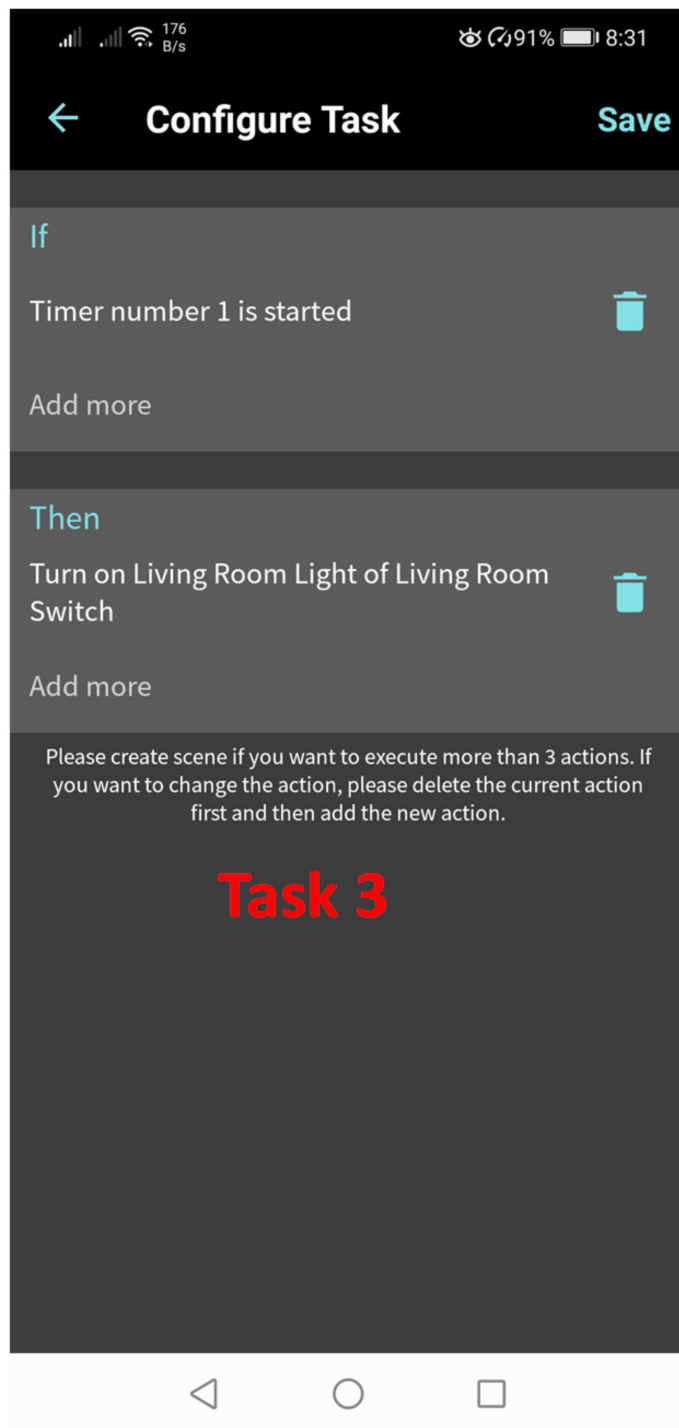

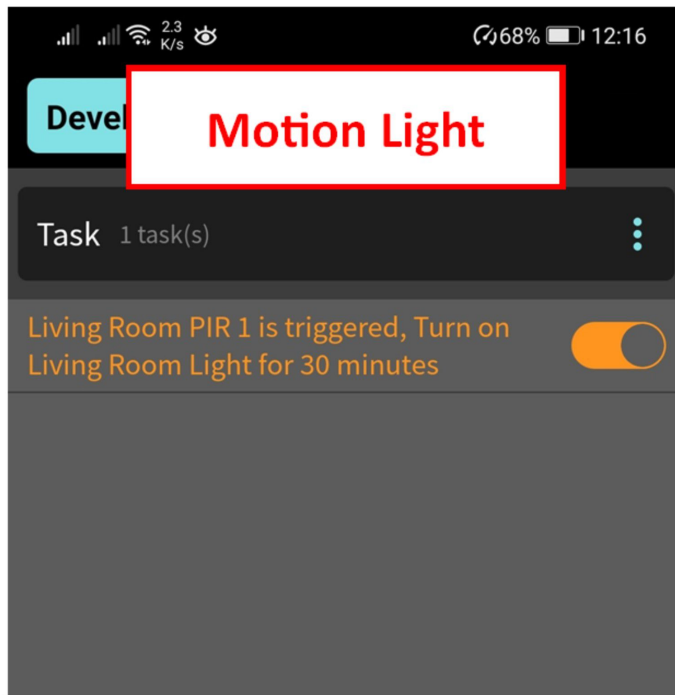

The difference between “Motion Light” and “Motion Light with Timer” :

Motion Light :

When the light is turned on by motion, and user physically turn off the light by touch, the light will still be turning on when motion is detected.

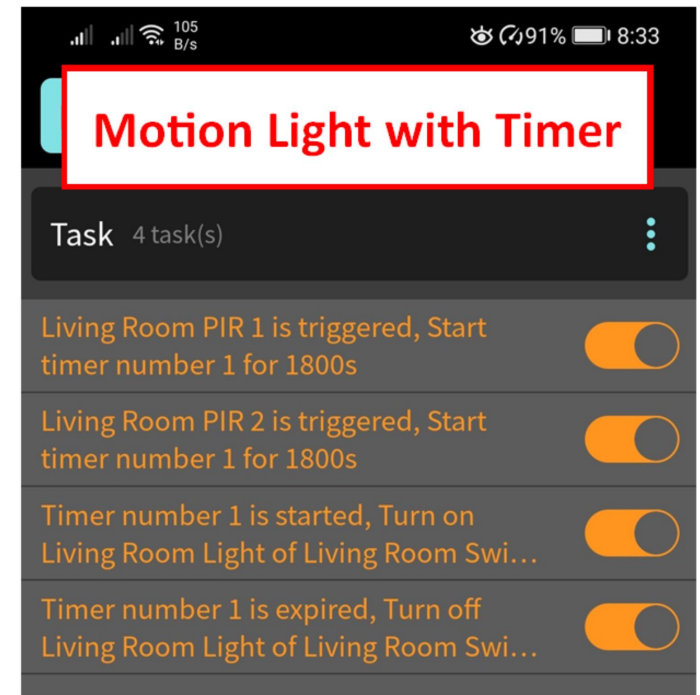

The difference between “Motion Light” and “Motion Light with Timer” :

Motion Light with Timer :

When the light is turned on by motion, and user physically turn off the light by touch, the light will **NOT** be turning on when motion is detected until the timer expired.

If

Living Room PIR 1 is triggered

Add more **Task 1**

Then

Start timer number 1 for 1800s

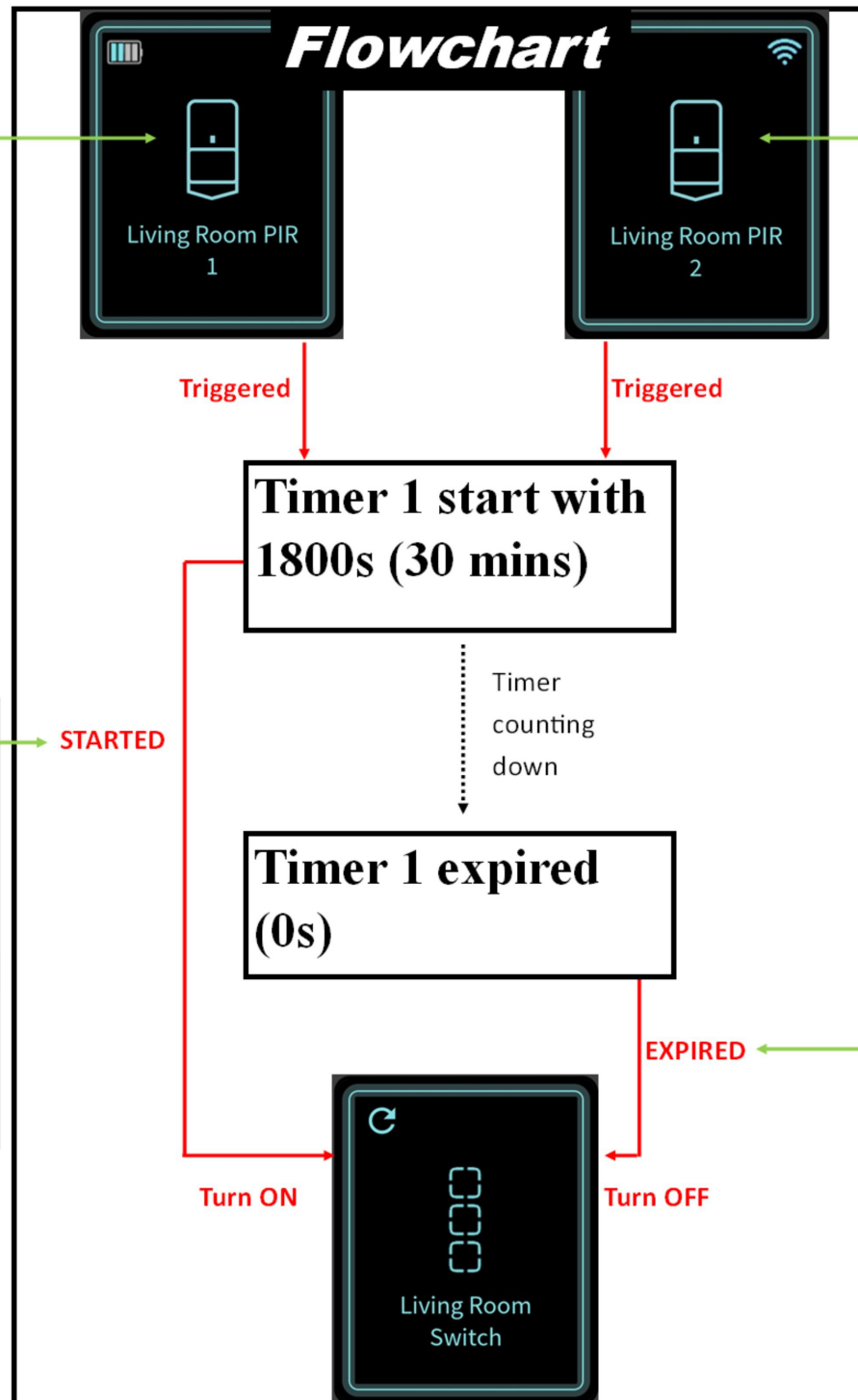

If

Living Room PIR 2 is triggered

Add more **Task 2**

Then

Start timer number 1 for 1800s

If **Task 3**

Timer number 1 is started

Add more

Then

Turn on Living Room Light of Living Room Switch

If

Timer number 1 is expired

Add more

Then **Task 4**

Turn off Living Room Light of Living Room Switch