

# SOLAR 4G CAMERA

## Quick Start Guide

# Camera Structure

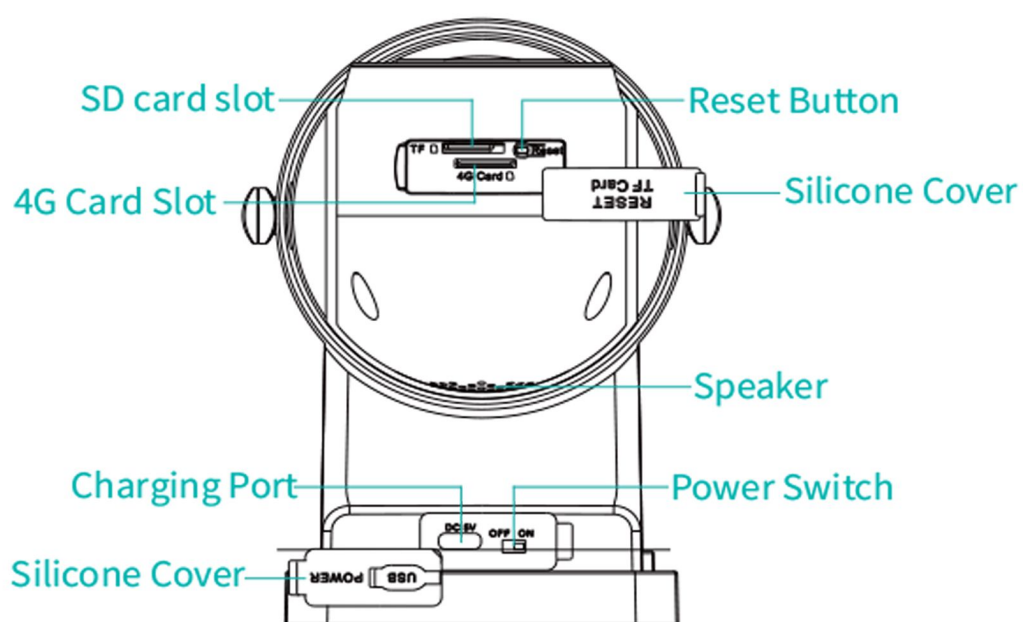
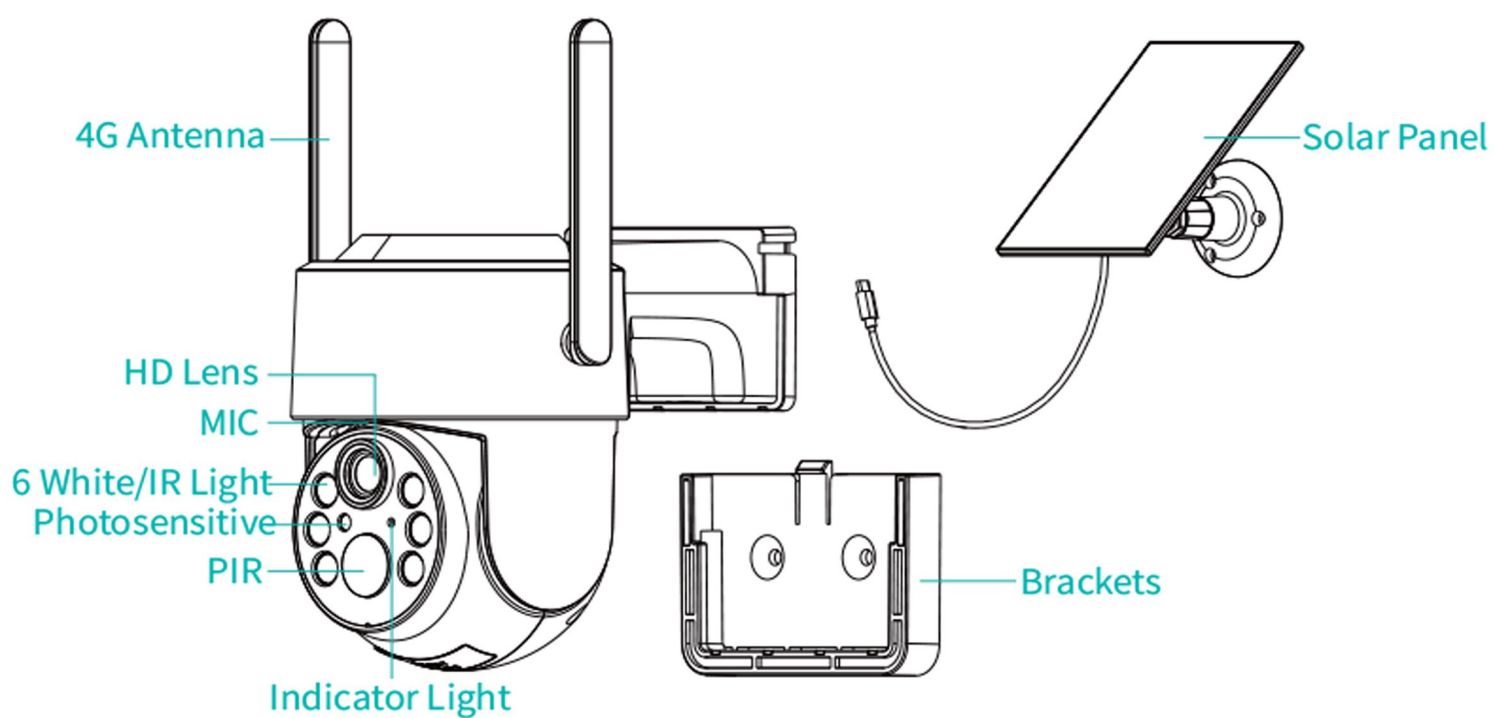

# Camera Operation

Warning: Please install the SIM card before turning on the 4G camera. Otherwise the network will not be available if the SIM card inserted after the device on. Insert the SIM card in the correct direction: the missing corner is facing the reset button, and the side with the metal chip is facing the front of the camera.

Step 1: Insert the SIM card

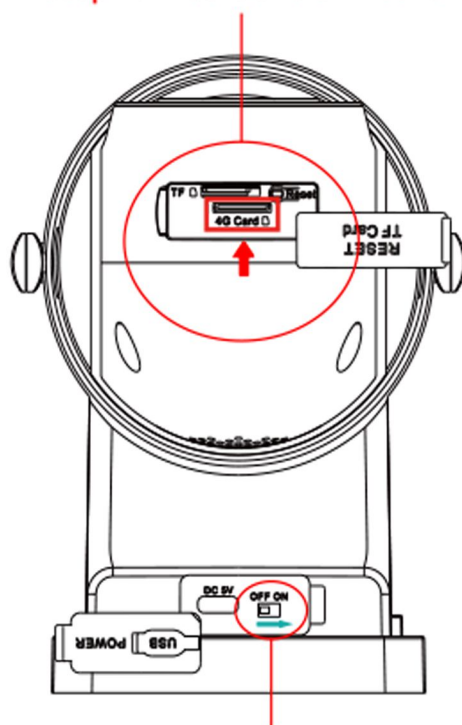

Step 2: Turn on the power switch

Indicator light description	
Blue light flash	Connect the network successfully
Red light on	Low battery
Blue light always on	Power run out / Network abnormal

Local storage is necessary, please install the TF card firstly, then turn on the camera power switch. Please note: TF card does not support hot-swap, so turn off the camera power switch and then plug or unplug.

## Quick Configuration

### Step 1 Insert the SIM card

Keep the device powered off, insert the SIM card in the correct direction, and you will hear a click.

### Step 2 Download and install the APP

Tips one: Scan the QR code below to download the APP.



Tip two: Search “iCSee” in the App store or Google play, and then download to install.

### Step 3 Configure the network of the camera

1. Open the iCSee app , register an account and login (Figure 1).
2. After successfully login, Click the "+" button to add the camera (Figure 2).

Figure 1

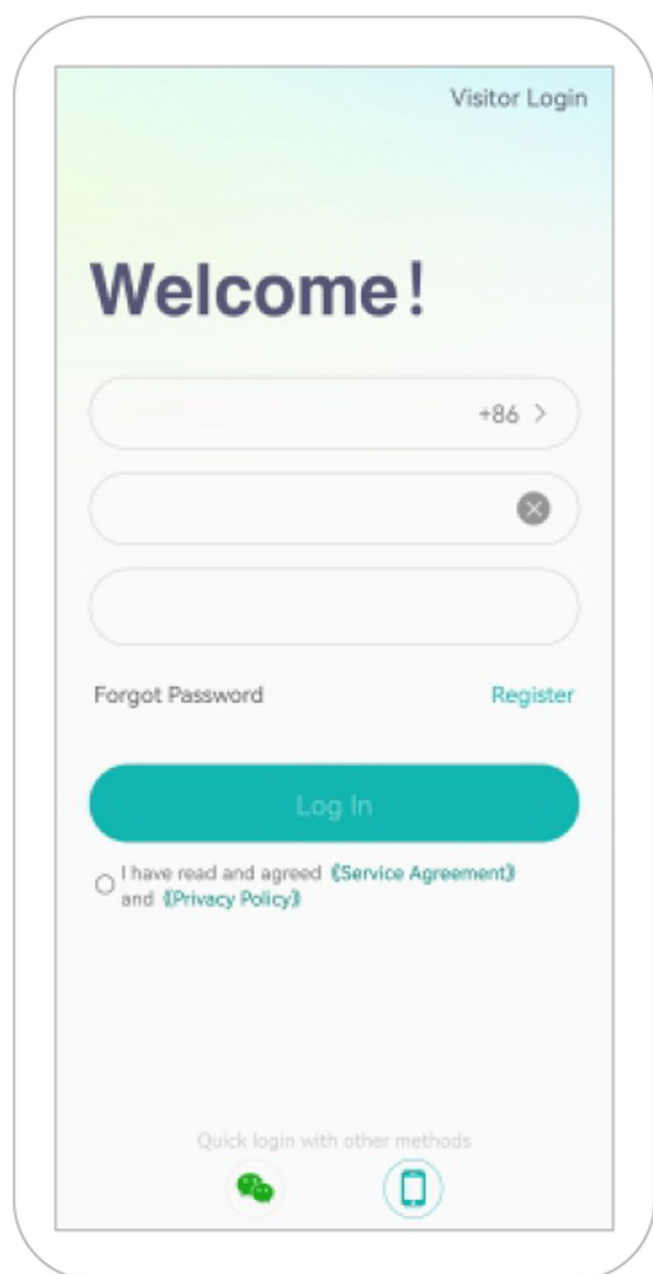
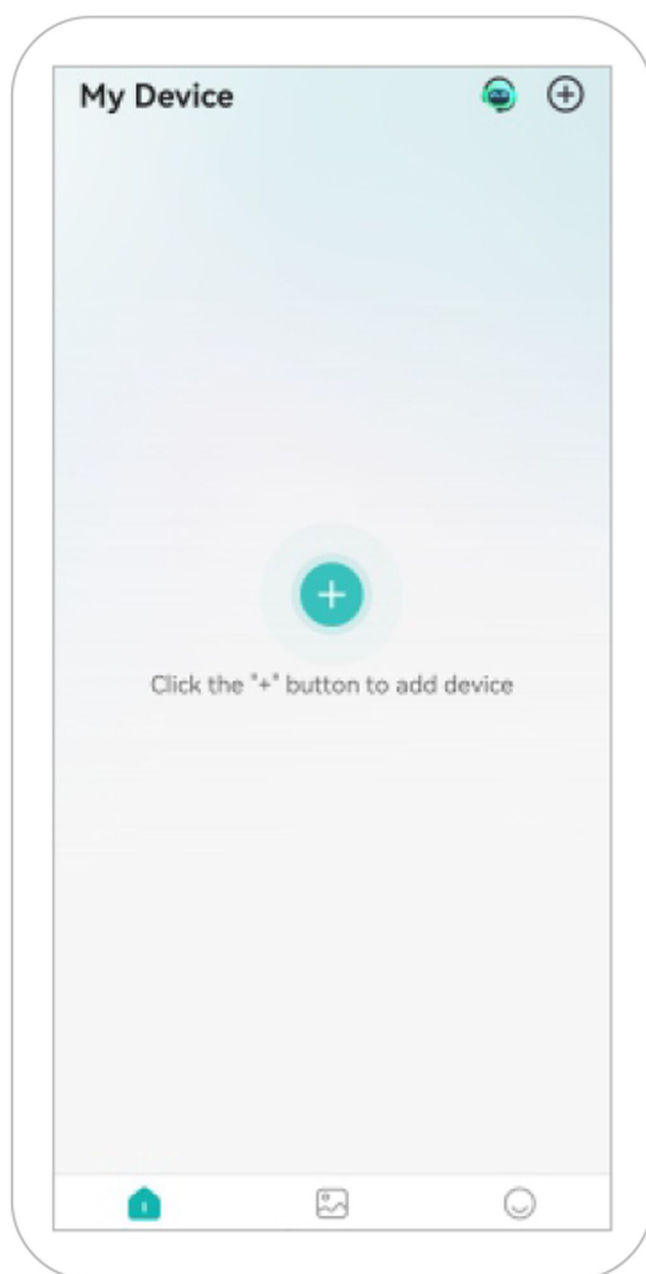

Figure 2



3. Click the “4G Camera” (Figure 3).

4. Turn on the camera power switch, and wait the camera to connect the internet successfully. (Figure 4).

Please confirm again the SIM card is correctly installed. Open the silicone cover, turn on the camera power switch, then the indicator light will flash. If not like this, charging the 4G camera firstly.

Figure 3

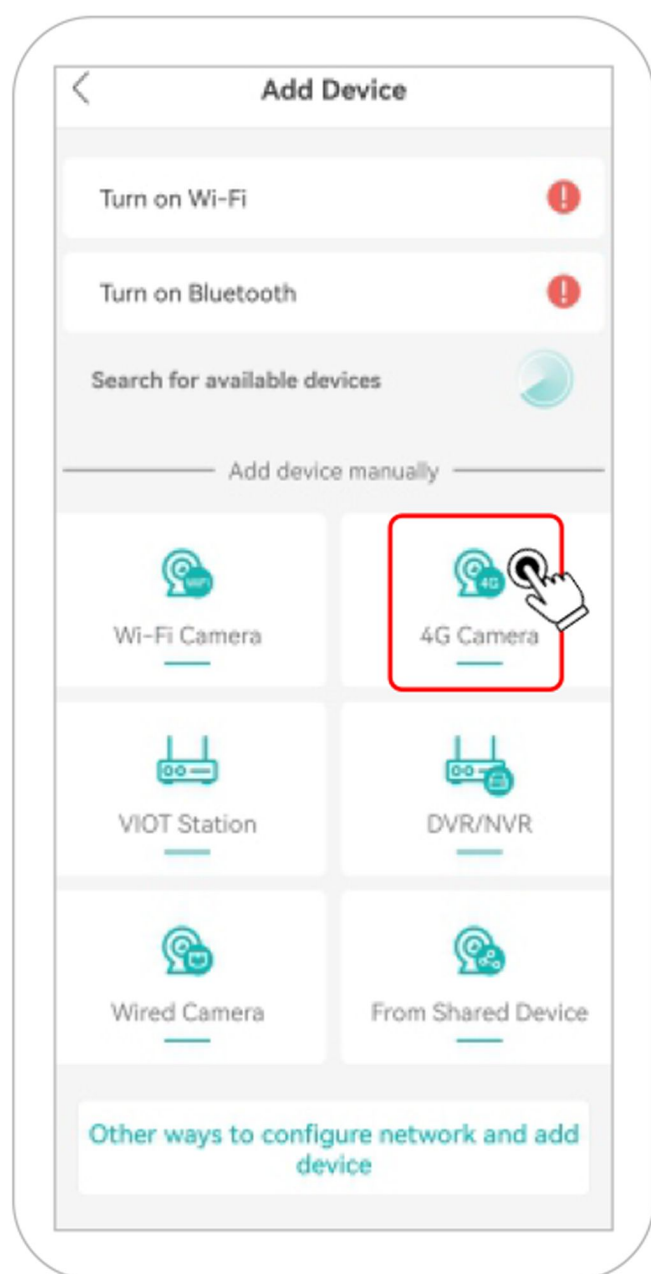
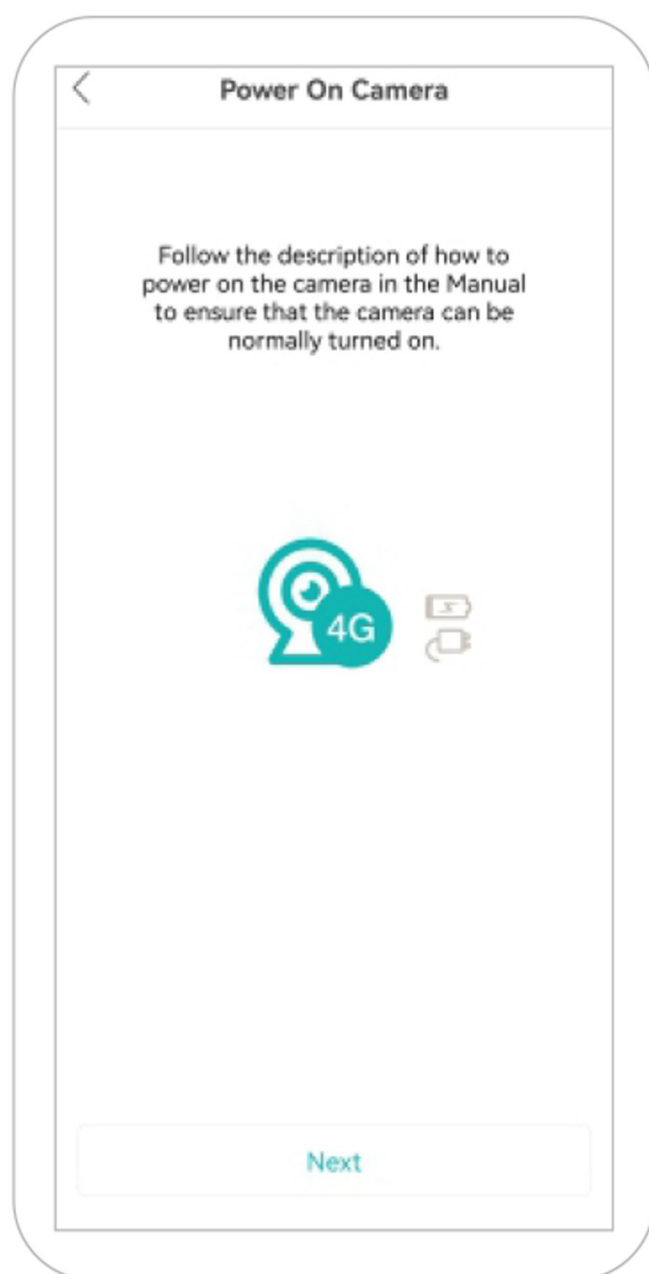

Figure 4





5. Follow the steps on the app interface (Figure 5) to scan the QR code on the camera body label (Figure 6).

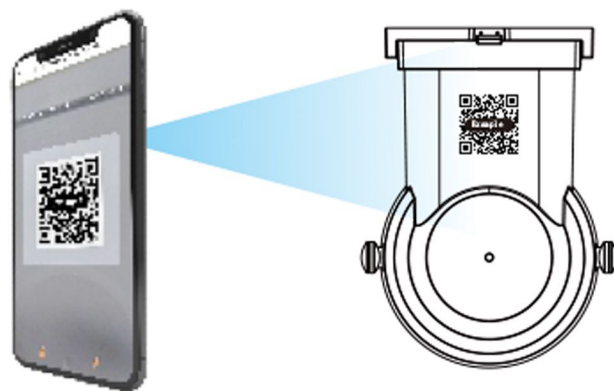
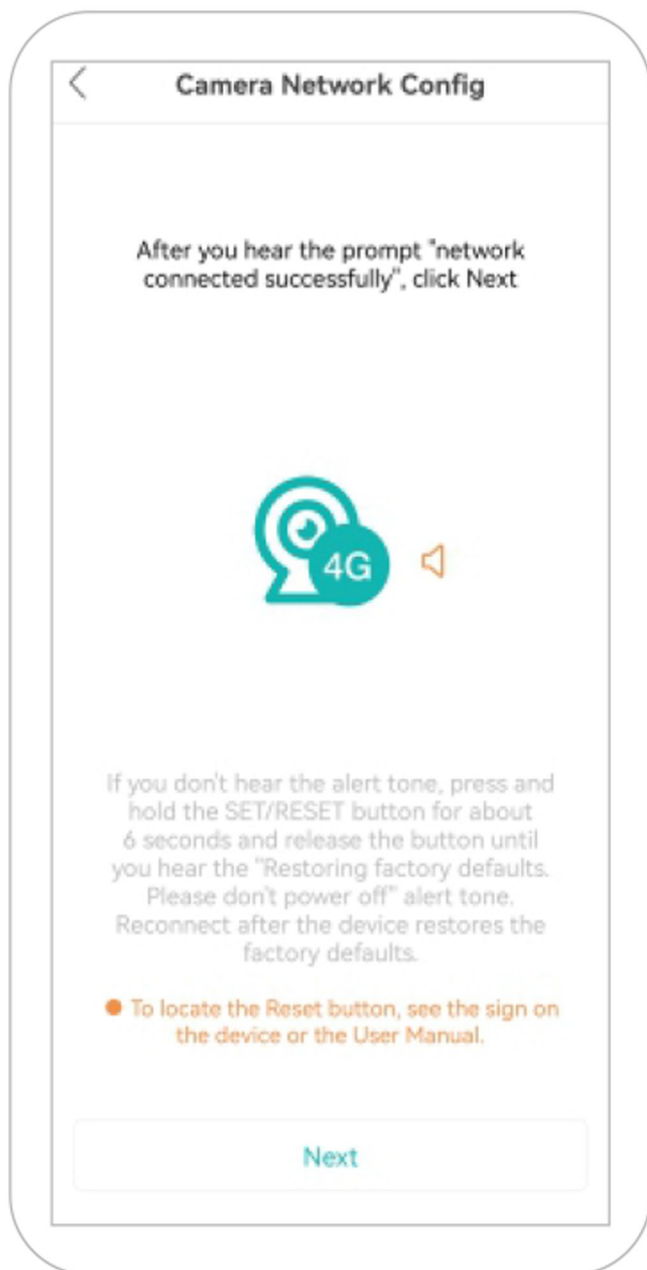

Figure 5

Figure 6



6. Scan the QR code successfully, it will show below (Figure 7),  
The type of device, the default is [Monitor], please must change to [Low power device]
7. Add the camera successfully, it will request you to set the camera password. (Figure 8)
8. Set the device name, and then click “completed”. The added cameras will be displayed under my device list. (Figure 9 and 10)

Figure 7

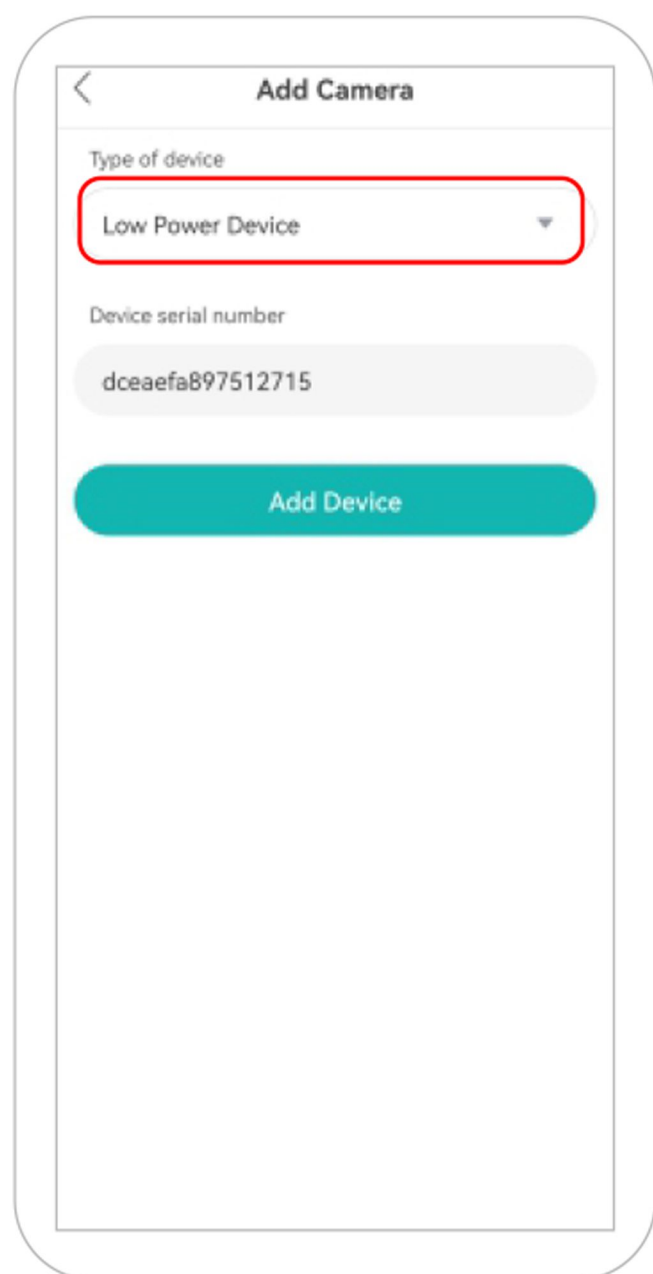
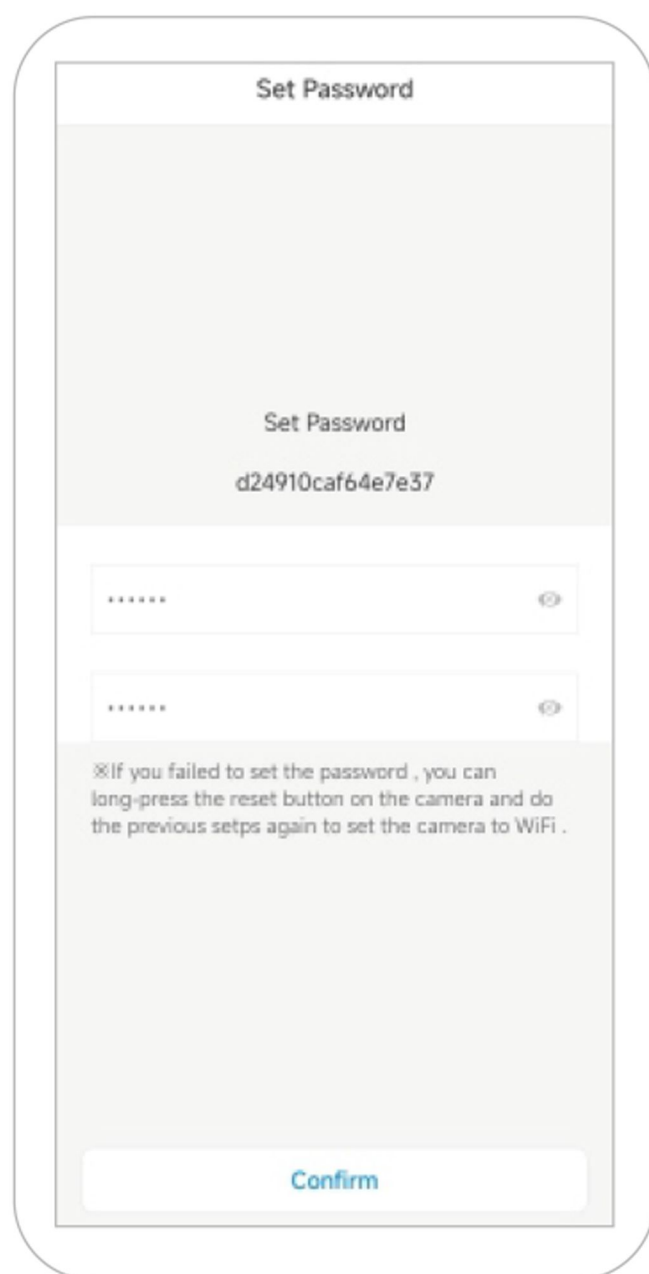



Figure 8





9. Click the  button, you can view the live. (Figure 10)

If it is failed to add the camera, please check the SIM card is correctly installed or not. Turn off the camera power, take out the card, plug in again, then turn on the camera power, long press the reset button for 5-10s until you hear a prompt tone, scan the QR code to add.

Figure 9

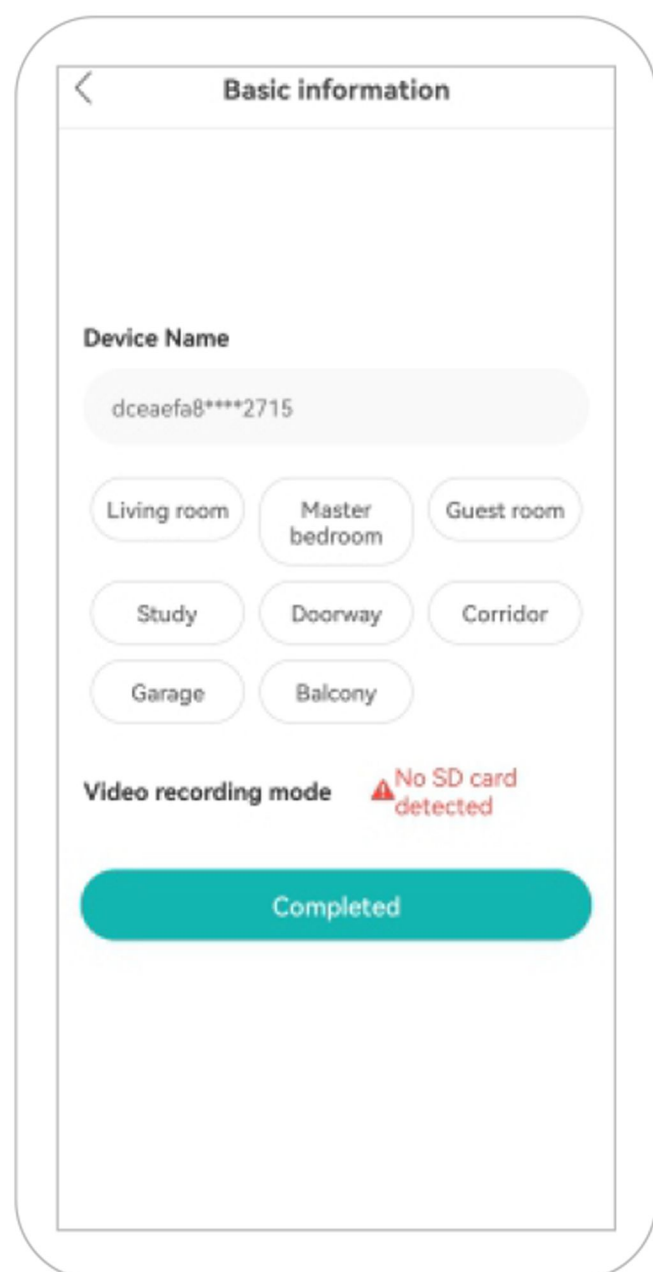
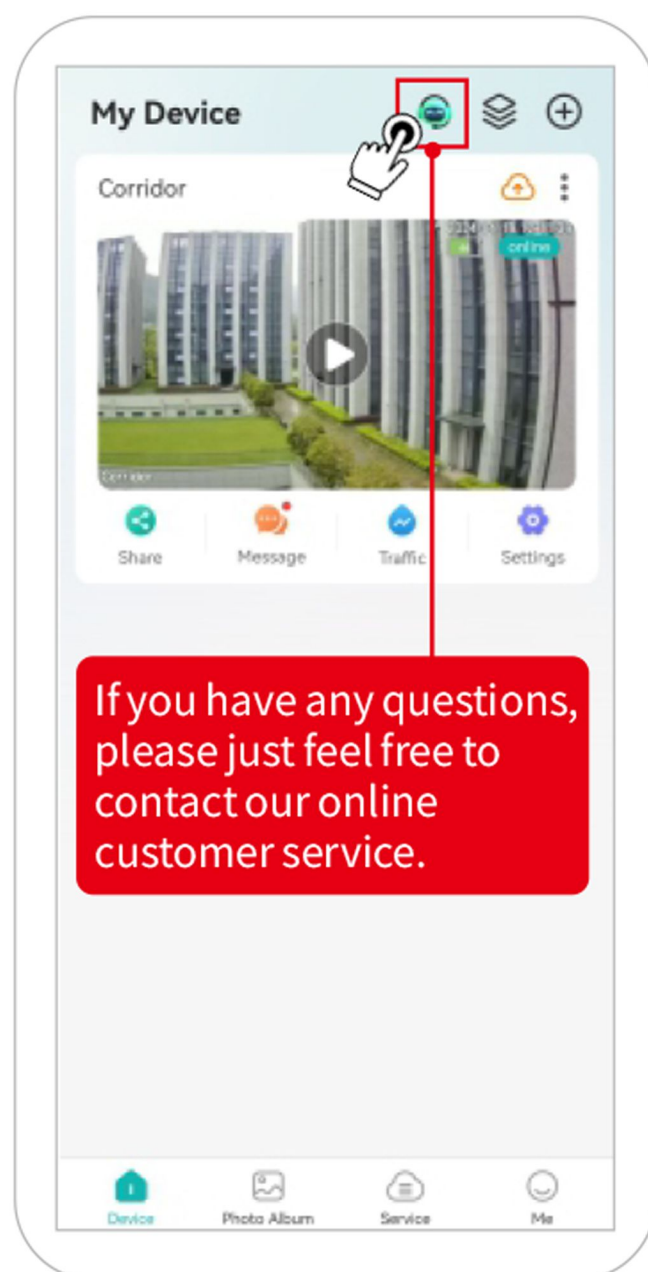

Figure 10



## Notice

1. Please change the password immediately when you start to use it
2. Do not install the camera in the place where is damp, dusty or accessible to children.
3. Please keep them in the allowable temperature and humidity range, do not disassemble the camera.

## Directions

1. Please refer the actual product, the quick start guide is subject to change without notice.
2. The App and product firmware will be updated from time to time. You can upgrade the latest firmware by online.
3. The quick start guide may have inaccurate parts. Please refer our company' s final explanation.